

SET-TZB (INCH) / SETS (INCH) Hexalobular Socket Head Cap Screws with Super Ultra Low Profile (Inch Thread)

SUS Stainless steel Protrusion

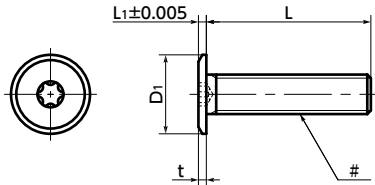

Material/Finish

	SET-TZB (INCH)	SETS (INCH)
Main Body	Steel Trivalent Chromate Treatment	SUSXM7 (Equivalent to SUS304)



- Hexalobular socket \*1 head cap screw with extra low profile.
- All head heights are 1 mm (0.04 in) or less.
- For space-saving of equipment/devices and applications with limited overhead space.
- Hexalobular socket shapes\*1 are designed to withstand high tightening torque. ➡ P.xxxx
- Install and remove with **SKX** Dedicated Wrench or **SKXB** Dedicated Bit and **SRD** Dedicated Magnetic Screwdriver together.
- Use the **SKX-N** hexalobular wrench for extremely limited access spaces for mounting and removing in tight spaces.
- We manufacture products with special specifications such as ventilation holes, nylon patches, cleanroom washing and special packaging.  
➡ P.xxxx



\*1 : The hexalobular shape is prescribed by JIS B 1015: 2008(ISO 10664: 2005)"Hexalobular internal driving feature for bolts and screws".

Application

Reducing the size of equipment and devices  
Equipment and devices using inch screw specifications

SET-TZB (INCH) Made of Steel

Part Number	# Nominal of Thread	L	D1	L1	Applicable Wrench	Hexalobular Socket No.	t	Max. Torque (N·m)	Mass (g)	Qty per pack
SET-#6-32-TZB	No.6-32UNC	1 / 2 1 / 4 3 / 4 3 / 8	0.295	0.034	SKX-6	6	0.029	0.95	0.48 - 1.2	10
SET-#8-32-TZB	No.8-32UNC	1 / 2 1 / 4 3 / 4 3 / 8	0.315	0.036	SKX-8	8	0.035	2.3	0.78 - 1.9	10
SET-#10-24-TZB	No.10-24UNC	1 / 2 3 / 4 5 / 8	0.335	0.038	SKX-8	8	0.035	2.4	1.6 - 2.3	10
SET-#10-32-TZB	No.10-32UNF	1 / 2 3 / 4 5 / 8	0.335	0.038	SKX-8	8	0.035	2.4	1.7 - 2.4	10

When purchasing less volume than one full bag, a separate handling fee is charged. For details, see the Sold Separately Service.

Related Products

**SKX** Hexalobular Wrench



**SKX-N** Hexalobular Wrench for Extremely Limited Access Spaces



**SKXB** Hexalobular Short Bit



**SRD** Magnet Screwdriver



Part number specification

SET-#6-32-1/4-TZB

1 2 1

Individual Sales ➡ P.xxxx Cleanroom Wash & Packaging ➡ P.xxxx Screw Length Adjustment ➡ P.xxxx Vibration Resistant ➡ P.xxxx Modification process for captive use ➡ P.xxxx  
Available / Add'l charge Available / Add'l charge Available / Add'l charge Available / Add'l charge Please feel free to contact us

SETS (INCH) Made of Stainless Steel

Part Number	# Nominal of Thread	L	D1	L1	Applicable Wrench	Hexalobular Socket No.	t	Max. Torque (N·m)	Mass (g)	Qty per pack
SETS-#4-40	No.4-40UNC	1 / 4 3 / 8 5 / 16	0.236	0.024	SKX-5	5	0.019	0.5	0.3 - 0.42	10
SETS-#6-32	No.6-32UNC	1 / 4 3 / 8 1 / 2 3 / 4	0.295	0.034	SKX-6	6	0.029	0.95	0.48 - 1.2	10
SETS-#8-32	No.8-32UNC	1 / 4 3 / 8 1 / 2 3 / 4	0.315	0.036	SKX-8	8	0.035	2.3	0.78 - 1.9	10
SETS-#10-24	No.10-24UNC	1 / 2 3 / 4 5 / 8	0.335	0.038	SKX-8	8	0.035	2.4	1.6 - 2.3	10
SETS-#10-32	No.10-32UNF	1 / 2 3 / 4 5 / 8	0.335	0.038	SKX-8	8	0.035	2.4	1.7 - 2.4	10

When purchasing less volume than one full bag, a separate handling fee is charged. For details, see the Sold Separately Service.