

# SPS-LC Plastic Screws - Socket Head Cap Screws with Low Profile - PPS

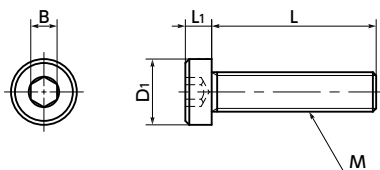

Protrusion 
 Heat-resistance 
 Chemical-proof 
 High Specific Strength



## ● Material/Finish



	SPS-LC
Main body	PPS (Poly Phenylene Sulfide) (Bright Light Brown) (Glass fiber 40%)
Heat resistance temperature*1	200℃



\*1 : A value of plastic materials. The allowable operating temperature of the product varies depending on use conditions such as tightening torque.

- Hex socket head cap screw with low head.
- For space-saving of equipment/device and applications with a limited top space.
- PPS is excellent in heat resistance and chemical resistance and continuously used at 200℃. No fat or organic solvent cannot dissolve PPS at 200℃ or below.
- High strength, high rigidity and high temperature strength is retained.
- It is highly frame-resistant satisfying V-0 of the UL standard 94.
- Plastic screw properties and precautions for use  
➔ P.xxxx

## ● Application

FPD production device / Semiconductor manufacturing device /  
Print board etching equipment / Metal surface treatment facility /  
Chemical plant / Transformer / Electric and electronic device /  
Hydrothermal pump / Chemical pump

Unit : mm

Part Number	M (Coarse)		L 									D1	L1	B	Tension*1 Rupture Load (N)	Torsional*1 Torque (N·m)	Mass (g)	Qty per pack	Unit : mm
	Nominal of Thread 	Pitch																	
SPS-M3-LC	M3	0.5	6	8	10	12	16	20				5.5	2	2	533	0.17	0.11 - 0.25	10	
SPS-M4-LC	M4	0.7	6	8	10	12	16	20	25			7	2.8	2.5	898	0.63	0.24 - 0.59	10	
SPS-M5-LC	M5	0.8		8	10	12	16	20	25	30		8.5	3.5	3	1568	1	0.38 - 1	10	
SPS-M6-LC	M6	1			10	12	16	20	25	30	40	10	4	4	1891	1.74	0.74 - 2.1	5	

\*1 : Values in chart are for reference only. They are not guaranteed values. The recommendation torque is 50% of the torsional torque.

- When purchasing less volume than one full bag, a separate handling fee is charged. For details, see the Sold Separately Service.

## ● Part number specification

### SPS - M5 - 30 - LC

Product Code 1 2 Product Code

Individual Sales ➔ P.xxxx	Cleanroom Wash & Packaging ➔ P.xxxx	Screw Length Adjustment ➔ P.xxxx	Vibration Resistant ➔ P.xxxx	Modification process for captive use ➔ P.xxxx
Available / Add'l charge	Available / Add'l charge	Available / Add'l charge	Not Available	Please feel free to contact us