

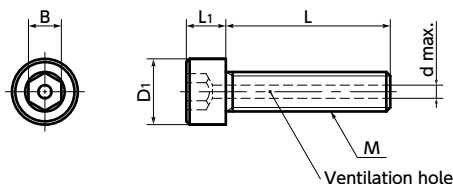

SVSH-C22 Vented Socket Head Cap Screws - Hastelloy C - 22 equiv.

Vacuum
 Cleanroom wash & packaging
 Chemical-proof



Material/Finish



	SVSH-C22
Main Body	UNS N06022 (Hastelloy*1C-22 equiv.)

*1: Hastelloy is a registered trademark of Haynes International, Inc.

Mechanical property

	Hastelloy (UNS N06022)	SUS304
Tensile Strength (N/mm ²)	690 or More	520 or More
0.2% Proof Load (N/mm ²)	310 or More	205 or More
Elongation (%)	45 or More	40 or More

• Values in chart are for reference only. They are not guaranteed values.

Physical property

	Hastelloy (UNS N06022)	SUS304
Specific Gravity	8.69	7.93
Longitudinal Elastic Modulus (GPa)	206	193
Specific Heat (J/kg·K)	414	500
Electric Resistance ($\mu\Omega \cdot m$)	1.14	0.7
Linear Expansion Coefficient (K ⁻¹)	12.4×10^{-6}	17.3×10^{-6}

• Values in chart are for reference only. They are not guaranteed values.



Hastelloy C-22 hex socket head cap screws

SVSH-C22 with ventilation hole.

- The ventilation hole easily releases gas trapped in the screw holes of equipment and machines, and supports vacuum drawing of vacuum devices.
- Hastelloy C-22 is one of the few metals which can withstand wet chlorine gas, hypochlorite, and chlorine dioxide.
- Excellent corrosion resistance against oxidizing and reducing acids and salts. ➔ P.xxxx
- Supports use with vacuum equipment in corrosive environments.
- Cleanroom wash/cleanroom packing provided. ➔ P.xxxx

Application

Vacuum devices / Vacuum chambers / FPD production equipment / Semiconductor manufacturing equipment / Electron microscopes / Printed circuit board etching devices / Metallic surface treatment equipment and facilities / Chemical plants

Unit : mm

Part Number	M (Coarse)		L										D1	L1	B	d max.	Mass (g)
	Nominal of Thread	Pitch															
SVSH-M3-C22	M3	0.5	6	8	10	12	16	20					5.5	3	2.5	1.2	0.79 - 1.5
SVSH-M4-C22	M4	0.7		8	10	12	16	20	25				7	4	3	1.5	1.8 - 3.5
SVSH-M5-C22	M5	0.8			10	12	16	20	25				8.5	5	4	1.5	3 - 5.3
SVSH-M6-C22	M6	1				12	16	20	25	30			10	6	5	2	5.6 - 9.2
SVSH-M8-C22	M8	1.25					16	20	25	30	35		13	8	6	2	13 - 21

Part number specification

SVSH-M5-16-C22

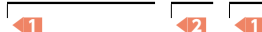

Batch cleanroom packing is provided for orders containing multiple items of the same size.

Individual Sales ➔ P.xxxx	Cleanroom Wash & Packaging ➔ P.xxxx	Screw Length Adjustment ➔ P.xxxx	Vibration Resistant ➔ P.xxxx	Modification process for captive use ➔ P.xxxx
1 piece in 1 pack	Cleanroom washed and packed	Available / Add'l charge	Not Available	Please feel free to contact us