

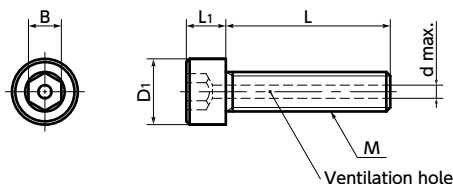

SVSM Vented Socket Head Cap Screws - Molybdenum

Vacuum
 Cleanroom wash & packaging
 Heat-resistance



Material/Finish



	SVSM
Main Body	Pure Molybdenum

Mechanical property

	Pure Molybdenum	SUS304
Tensile Strength (N/mm ²)	515	520 or More
0.2% Proof Load (N/mm ²)	380	205 or More
Elongation (%)	15	40 or More

• Values in chart are for reference only. They are not guaranteed values.

Physical property

	Pure Molybdenum	SUS304
Specific Gravity	10.2	7.93
Longitudinal Elastic Modulus (GPa)	327	193
Electric Resistance ($\mu\Omega \cdot m$)	0.058	0.7
Thermal Conductivity (W/(m·K))	142	17
Linear Expansion Coefficient (K ⁻¹)	5.1×10^{-6}	17.3×10^{-6}

• Values in chart are for reference only. They are not guaranteed values.

- Molybdenum hex socket head cap screws **SVSM** with ventilation hole.
- The ventilation hole easily releases gas trapped in the screw holes of equipment and machines, and supports vacuum drawing of vacuum devices.
- Melting point: 2623°C. Excellent heat resistance.
- Supports use with vacuum equipment in high-temperature environments.
- Cleanroom wash/cleanroom packing provided. ➔ P. xxxx

Application

Vacuum devices / Vacuum chambers / FPD production equipment / Semiconductor manufacturing equipment / Electron microscopes / Sputtering equipment / High-temperature furnaces



Precautions for Use

Note that in an oxidizing atmosphere, sublimation will begin at 600°C or higher.

Unit : mm

Part Number	M (Coarse)		L										D1	L1	B	d max.	Mass (g)
	Nominal of Thread	Pitch	6	8	10	12	16	20	25	30	35						
SVSM-M3	M3	0.5											5.5	3	2.5	1.2	0.93 - 1.8
SVSM-M4	M4	0.7											7	4	3	1.5	2.2 - 4.1
SVSM-M5	M5	0.8											8.5	5	4	1.5	3.5 - 6.3
SVSM-M6	M6	1											10	6	5	2	6.6 - 11
SVSM-M8	M8	1.25											13	8	6	2	16 - 25

Part number specification

SVSM-M5-16

Batch cleanroom packing is provided for orders containing multiple items of the same size.

Individual Sales ➔ P. xxxx	Cleanroom Wash & Packaging ➔ P. xxxx	Screw Length Adjustment ➔ P. xxxx	Vibration Resistant ➔ P. xxxx	Modification process for captive use ➔ P. xxxx
1 piece in 1 pack	Cleanroom washed and packed	Available / Add'l charge	Not Available	Please feel free to contact us