

SPE-C Plastic Socket Head Cap Screws - PEEK

Heat-resistance Chemical-proof Electrical Insulation

e-nedzi.com

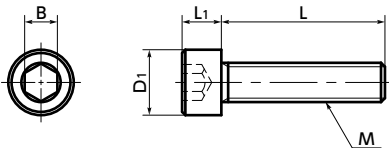

Material/Finish



	SPE-C
Main Body	PEEK (Polyether Ether Ketone) (Light Brown)
Heat Resistance Temperature*1	260°C

*1 : This is the value for the resin material. The operating temperature of the product changes with performance conditions such as tightening torque.

Precautions for Use

Because a cumulative pitch difference is created when PEEK screws are manufactured, use these screws with nuts. If a nut is not used, use a 20 mm or less fit with female thread.

- PEEK hex socket head cap screws.
- PEEK is a thermoplastic super engineering plastic superior in physical and chemical properties.
- Excellent chemical resistance. It remains almost unaffected by chemicals other than concentrated sulfuric acid, concentrated nitric acid, and concentrated hydrofluoric acid.
- With excellent heat resistance and water resistance, it retains strength at high temperatures.
- It features outstanding resistance to wear, shock, and fatigue.
- It also has high flame retardance which clears the UL 94 V-0 standard.
- For the properties and precautions for use of plastic screws, see "Properties of Plastic Screws."

Application

FPD production equipment / Semiconductor manufacturing equipment / Printed circuit board etching devices / Metallic surface treatment equipment and facilities / Chemical plants / Transformers / Electrical and electronic equipment / Hot water pumps / Chemical pumps



Part Number	M (Coarse)		L										D1	L1	B	Tensile Breaking Load*1 (N)	Torsional Torque*1 (N·m)	Mass (g)	Qty per Pack
	Nominal of Thread	Pitch																	
SPE-M3-C	M3	0.5	6	8	10	12	15	20	25				5.5	3	2.5	405	0.21	0.12 - 0.27	20
SPE-M3-C(100)	M3	0.5	6	8	10	12	15	20	25				5.5	3	2.5	405	0.21	0.12 - 0.27	100
SPE-M4-C	M4	0.7	6	8	10	12	15	20	25	30			7	4	3	738	0.47	0.25 - 0.61	20
SPE-M4-C(100)	M4	0.7	6	8	10	12	15	20	25	30			7	4	3	738	0.47	0.25 - 0.61	100
SPE-M5-C	M5	0.8	6	8	10	12	15	20	25	30			8.5	5	4	1234	0.96	0.37 - 0.93	10
SPE-M5-C(100)	M5	0.8	6	8	10	12	15	20	25	30			8.5	5	4	1234	0.96	0.37 - 0.93	100
SPE-M6-C	M6	1			10	12	15	20	25	30	35	40	10	6	5	1749	1.64	0.78 - 1.8	10
SPE-M6-C(100)	M6	1			10	12	15	20	25	30	35	40	10	6	5	1749	1.64	0.78 - 1.8	100
SPE-M8-C	M8	1.25			10	12	15	20	25	30	35	40	13	8	6	3261	3.68	1.8 - 3.5	5
SPE-M8-C(100)	M8	1.25			10	12	15	20	25	30	35	40	13	8	6	3261	3.68	1.8 - 3.5	100
SPE-M10-C	M10	1.5					15	20	25	30	35	40	16	10	8	5256	7.9	3.5 - 5.6	1
SPE-M10-C(50)	M10	1.5					15	20	25	30	35	40	16	10	8	5256	7.9	3.5 - 5.6	50
SPE-M12-C	M12	1.75						20	25	30	35	40	18	12	10	7650	13.64	5.5 - 8.0	1
SPE-M12-C(50)	M12	1.75						20	25	30	35	40	18	12	10	7650	13.64	5.5 - 8.0	50

*1 : Values in chart are for reference only. They are not guaranteed values. The recommended tightening torque is 50% of the torsional torque.

• When purchasing less volume than one full bag, a separate handling fee is charged. For details, see the Sold Separately Service.

Related Products

PEEK hex nuts **SPE-N** are available.



Part Number Specification

SPE-M5-20-C

1 2 1

Individual Sales	Cleanroom Wash & Packaging	Screw Length Adjustment	Vibration Resistant	Modification process for captive use
Available / Add'l charge	Available / Add'l charge	Available / Add'l charge	Not Available	Please feel free to contact us



WEB ▶ <https://www.nbk1560.com>



WEB ▶ <https://www.nbk1560.com>