

SPEG-C(INCH) Plastic Inch Socket Head Cap Screws - PEEK GF30

Heat-resistance Chemical-proof Electrical Insulation High Specific Strength

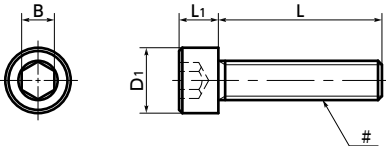

Material/Finish

	SPEG-C(INCH)
Main Body	PEEK GF30 (PEEK Containing Glass Fiber) (Light Brown) (Glass Fiber 30%)
Heat Resistance Temperature*1	260°C

*1 : This is the value for the resin material. The operating temperature of the product changes with performance conditions such as tightening torque.

Precautions for Use

Because a cumulative pitch difference is created when PEEK screws are manufactured, use these screws with nuts. If a nut is not used, use a 20 mm (approx. 0.79") or less fit with female thread.

- Hex head screws made of PEEK containing 30% glass fiber. The tensile strength is approximately 1.7 times that of ordinary PEEK.
- Inch screw type.
- PEEK is a thermoplastic super engineering plastic superior in physical and chemical properties.
- Excellent chemical resistance. It remains almost unaffected by chemicals other than concentrated sulfuric acid, concentrated nitric acid, and concentrated hydrofluoric acid.
- With excellent heat resistance and water resistance, it retains strength at high temperatures.
- It features outstanding resistance to wear, shock, and fatigue.
- It also has high flame retardance which clears the UL 94 V-0 standard.
- For the properties and precautions for use of plastic screws, see "Properties of Plastic Screws."

Application

FPD production equipment / Semiconductor manufacturing equipment / Printed circuit board etching devices / Metallic surface treatment equipment and facilities / Chemical plants / Transformers / Electrical and electronic equipment / Hot water pumps / Chemical pumps



Part Number	# Nominal of Thread	L								D1	L1	B	Tensile Breaking Load*1 (N)	Torsional Torque*1 (N・m)	Mass (g)	Qty per Pack
		3 / 16	1 / 4	5 / 16	3 / 8											
SPEG-#2-56-C	No.2-56UNC	3 / 16	1 / 4	5 / 16	3 / 8					0.14	0.086	5 / 64	276	0.11	0.03 - 0.11	10
SPEG-#2-56-C(100)	No.2-56UNC	3 / 16	1 / 4	5 / 16	3 / 8					0.14	0.086	5 / 64	276	0.11	0.03 - 0.11	100
SPEG-#4-40-C	No.4-40UNC		1 / 4	5 / 16	3 / 8	1 / 2	5 / 8	3 / 4	7 / 8	1	0.183	0.112	3 / 32	434	0.23	0.1 - 3.8
SPEG-#4-40-C(100)	No.4-40UNC		1 / 4	5 / 16	3 / 8	1 / 2	5 / 8	3 / 4	7 / 8	1	0.183	0.112	3 / 32	434	0.23	0.1 - 3.8
SPEG-#6-32-C	No.6-32UNC		1 / 4	5 / 16	3 / 8	1 / 2	5 / 8	3 / 4	7 / 8	1	0.226	0.138	7 / 64	644	0.44	0.16 - 0.3
SPEG-#6-32-C(100)	No.6-32UNC		1 / 4	5 / 16	3 / 8	1 / 2	5 / 8	3 / 4	7 / 8	1	0.226	0.138	7 / 64	644	0.44	0.16 - 0.3
SPEG-#8-32-C	No.8-32UNC		1 / 4	5 / 16	3 / 8	1 / 2	5 / 8	3 / 4	7 / 8	1	0.27	0.164	9 / 64	1017	0.79	0.18 - 0.32
SPEG-#8-32-C(100)	No.8-32UNC		1 / 4	5 / 16	3 / 8	1 / 2	5 / 8	3 / 4	7 / 8	1	0.27	0.164	9 / 64	1017	0.79	0.18 - 0.32
SPEG-#10-32-C	No.10-32UNF				3 / 8	1 / 2	5 / 8	3 / 4	7 / 8	1	0.312	0.19	5 / 32	1424	1.17	0.24 - 0.34
SPEG-#10-32-C(100)	No.10-32UNF				3 / 8	1 / 2	5 / 8	3 / 4	7 / 8	1	0.312	0.19	5 / 32	1424	1.17	0.24 - 0.34
SPEG-1 / 4-20-C	1/4-20UNC				3 / 8	1 / 2	5 / 8	3 / 4	7 / 8	1	0.375	0.25	3 / 16	2160	2.5	0.26 - 0.36
SPEG-1 / 4-20-C(100)	1/4-20UNC				3 / 8	1 / 2	5 / 8	3 / 4	7 / 8	1	0.375	0.25	3 / 16	2160	2.5	0.26 - 0.36

*1 : Values in chart are for reference only. They are not guaranteed values. The recommended tightening torque is 50% of the torsional torque.

When purchasing less volume than one full bag, a separate handling fee is charged. For details, see the Sold Separately Service.

Individual Sales	Cleanroom Wash & Packaging	Screw Length Adjustment	Vibration Resistant	Modification process for captive use
Available / Add'l charge	Available / Add'l charge	Available / Add'l charge	Not Available	Please feel free to contact us

Related Products

PEEK hex nuts (inch screw) SPE-N(INCH) are available.



Part Number Specification

SPEG-#4-40-1/4-C