

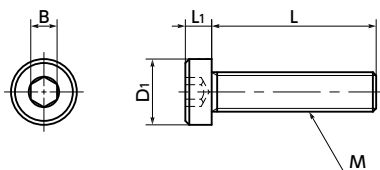

SPA-LC

Plastic Low Profile Socket Head Screws - RENY

Protrusion
 Lightweight
 High Specific Strength



Material/Finish



SPA-LC	
Main Body	RENY™*1 (50% Glass Fiber Reinforced Polyamide MXD6) (Black)
Heat Resistance Temperature*2	105°C

*1: RENY™ is a trademark or registered trademark of Mitsubishi Gas Chemical Company, Inc.

*2: This is the value for the resin material. The operating temperature of the product changes with performance conditions such as tightening torque.

Part Number Specification

SPA-M5-30-LC



- RENY™ low profile cap screws.
- For space-saving of equipment/devices and applications with limited overhead space.
- RENY™ is a thermoplastic engineering plastic with excellent tensile and bending strength.
- It is highly fatigue-resistant and has excellent creep and heat insulation properties.
- While it is nearly as strong as metal, its weight is approximately 1/5 of iron.
- For the properties and precautions for use of plastic screws, see "Properties of Plastic Screws."

Application

Heat insulation and dew condensation prevention of refrigerating and freezing facilities
Electrical and electronic equipment / Offshore instruments / Plating facilities

Unit : mm

Part Number	M (Coarse)		L								D ₁	L ₁	B	Tensile Breaking Load*1 (N)	Torsional Torque*1 (N・m)	Mass (g)	Qty per Pack	
	Nominal of Thread	Pitch																
SPA-M3-LC	M3	0.5	6	8	10	12	16	20			5.5	2	2	799	0.2	0.11 - 0.25	20	
SPA-M3-LC(100)	M3	0.5	6	8	10	12	16	20			5.5	2	2	799	0.2	0.11 - 0.25	100	
SPA-M3-LC(1000)	M3	0.5	6	8	10	12	16	20			5.5	2	2	799	0.2	0.11 - 0.25	1000	
SPA-M4-LC	M4	0.7	6	8	10	12	16	20	25		7	2.8	2.5	1286	0.74	0.24 - 0.58	20	
SPA-M4-LC(100)	M4	0.7	6	8	10	12	16	20	25		7	2.8	2.5	1286	0.74	0.24 - 0.58	100	
SPA-M4-LC(1000)	M4	0.7	6	8	10	12	16				7	2.8	2.5	1286	0.74	0.24 - 0.4	1000	
SPA-M4-LC(500)	M4	0.7						20	25		7	2.8	2.5	1286	0.74	0.48 - 0.58	500	
SPA-M5-LC	M5	0.8	6	8	10	12	16	20	25	30	8.5	3.5	3	1976	1.08	0.39 - 1	20	
SPA-M5-LC(100)	M5	0.8	6	8	10	12	16	20	25	30	8.5	3.5	3	1976	1.08	0.39 - 1	100	
SPA-M5-LC(500)	M5	0.8	6	8	10	12	16	20			8.5	3.5	3	1976	1.08	0.39 - 0.71	500	
SPA-M5-LC(250)	M5	0.8							25	30	8.5	3.5	3	1976	1.08	0.87 - 1	250	
SPA-M6-LC	M6	1			10	12	16	20	25	30	40	10	4	4	2767	2.26	0.75 - 2.1	20
SPA-M6-LC(100)	M6	1			10	12	16	20	25	30	40	10	4	4	2767	2.26	0.75 - 2.1	100
SPA-M6-LC(500)	M6	1			10	12	16					10	4	4	2767	2.26	0.75 - 0.96	500
SPA-M6-LC(250)	M6	1						20	25			10	4	4	2767	2.26	1.1 - 1.3	250
SPA-M6-LC(200)	M6	1								30		10	4	4	2767	2.26	1.5	200

*1: Values in chart are for reference only. They are not guaranteed values. The recommended tightening torque is 50% of the torsional torque.

• When purchasing less volume than one full bag, a separate handling fee is charged. For details, see the Sold Separately Service.

Individual Sales	Cleanroom Wash & Packaging	Screw Length Adjustment	Vibration Resistant	Modification process for captive use
Available / Add'l charge	Available / Add'l charge	Not Available	Not Available	Not Available