

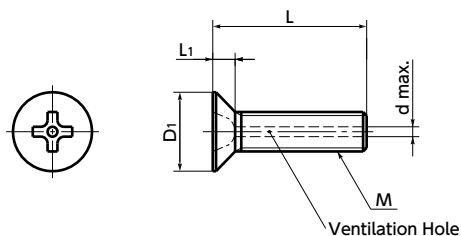

# SVFS Vented Cross Recessed Flat Head Machine Screws

Vacuum 
 Protrusion 
 Cleanroom wash & packaging 
 SUS Stainless steel



- The ventilation hole easily releases gas trapped in the screw holes of equipment and machines, and supports vacuum drawing of vacuum devices.
- The flat head does not protrude after tightening.
- Cleanroom wash and cleanroom packing are completed.

## • Application

Vacuum devices, vacuum chambers, FPD production equipment, semiconductor devices, and electron microscopes

## • Material/Finish



	SVFS
Main Body	SUSXM7 (Equivalent to SUS304)

Unit : mm

Part Number 	M (Coarse)		L 								D1	L1	d	Cross-recessed Socket Number	Mass (g)	Qty per pack	
	Nominal of Thread	Pitch															
SVFS-M2	M2	0.4	3	4	5	6	8				4	1.2	0.8	1	0.13 - 0.21	10	
SVFS-M2.6	M2.6	0.45		4	5	6	8	10			5.2	1.5	1	1	0.27 - 0.46	10	
SVFS-M3	M3	0.5			5	6	8	10	12		6	1.75	1.2	2	0.49 - 0.77	20	
SVFS-M4	M4	0.7				6	8	10	12	16	8	2.3	1.5	2	1 - 1.8	20	
SVFS-M5	M5	0.8					8	10	12	16	10	2.8	1.5	2	2.2 - 3.1	10	
SVFS-M6	M6	1						10	12	16	20	12	3.4	2	3	3.9 - 5.6	10

• When purchasing less volume than one full bag, a separate handling fee is charged. For details, see the Sold Separately Service.

## • Usage example

Effective with vacuum devices and vacuum chambers that require the exhaustion of gas trapped in screw holes.

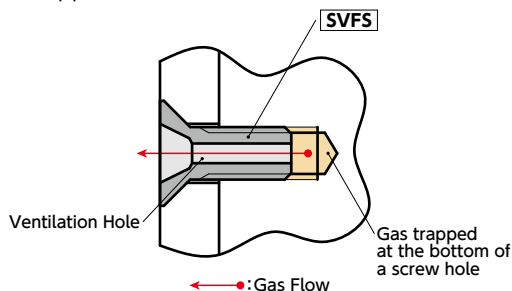

## • Part number specification

### SVFS-M4-12

Individual Sales	Cleanroom Wash & Packaging	Screw Length Adjustment	Vibration Resistant	Modification process for captive use
Available / Add'l charge	Cleanroom washed and packed	Available / Add'l charge	Not Available	Not Available